

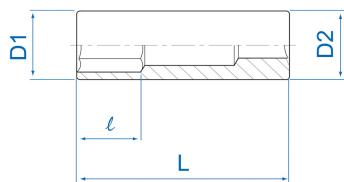
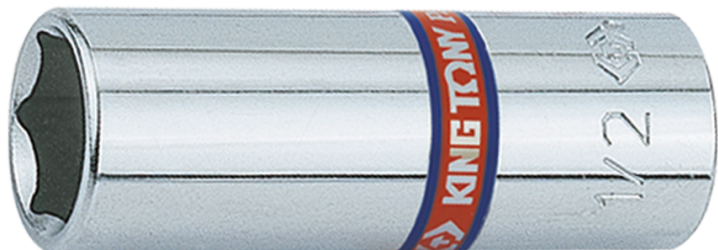

2235S

S Steckschlüsseinsatz, metrisch, Zoll, 6-Kant 1/4"

ANSI / ASME B107.1

- Zoll
- Chrom-Vanadium, hochglanz-verchromt



|  | Abmessung (Zoll) | D1 (mm) | D2 (mm) | L (mm) | l (mm) | Gewicht (g) |
|--|---------------------|---------|---------|--------|--------|-------------|
| 223505S | 5/32" | 6.8 | 11.8 | 50 | 6 | 24 |
| 223506S | 3/16" | 7.9 | 11.8 | 50 | 7 | 24 |
| 223507S | 7/32" | 8.7 | 11.8 | 50 | 9 | 25 |
| 223508S | 1/4" | 9.5 | 11.8 | 50 | 9 | 25 |
| 223509S | 9/32" | 10.3 | 11.8 | 50 | 15 | 25 |
| 223510S | 5/16" | 11.8 | 11.8 | 50 | 15 | 24 |
| 223511S | 11/32" | 13 | 13 | 50 | 15 | 31 |
| 223512S | 3/8" | 14.5 | 14.5 | 50 | 15 | 34 |
| 223514S | 7/16" | 15.8 | 15.8 | 50 | 21 | 46 |
| 223516S | 1/2" | 17.6 | 17.6 | 50 | 21 | 56 |
| 223518S | 9/16" | 19,6 | 19,4 | 50 | 21 | 52,2 |