

3330S



S Steckschlüsseinsatz, Zoll, Standard, 12-Kant 3/8"

ANSI / ASME B107.1

- Zoll
- Chrom-Vanadium, hochglanz-verchromt

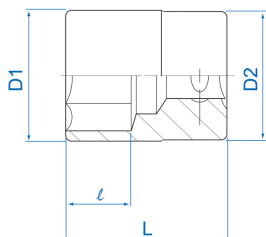

	Abmessung (Zoll)	D1 (mm)	D2 (mm)	L (mm)	l (mm)	Gewicht (g)
333008S	1/4"	10	17.8	27	7	25
333010S	5/16"	12	17.8	27	7	22
333011S	11/32"	13.2	17.8	27	7	25
333012S	3/8"	14	17.8	27	9	26
333014S	7/16"	15.8	17.8	27	9	27
333015S	15/32"	16.8	17.8	27	9	25
333016S	1/2"	17.8	16.8	27	9	30
333018S	9/16"	19.7	18	29	11	33
333019S	19/32"	20.8	18	29	11	41
333020S	5/8"	21.8	20	29	11	43
333022S	11/16"	23.8	20	29	11	52
333024S	3/4"	25.8	21	29	13	62
333026S	13/16"	27.8	25	32	13	77



KING TONY

Enjoy your work

333028S	7/8"	29.7	26	32	15	87
333030S	15/16"	31.8	26	34	17	83
333032S	1"	33.8	26	34	17	96