

6330M

M

Steckschlüsseinsatz, metrisch, Standard, 12-Kant 3/4"

DIN 3124

- Metrisch
- Chrom-Vanadium, hochglanz-verchromt

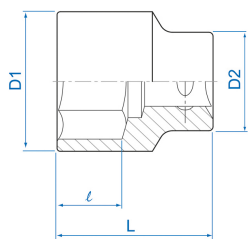

|  | Abmessungen (mm) | D1 (mm) | D2 (mm) | L (mm) | l (mm) | Gewicht (g) |
|--|------------------|---------|---------|--------|--------|-------------|
| 633017M | 17 | 26 | 32,7 | 51 | 14 | 187 |
| 633019M | 19 | 30 | 36 | 52 | 14 | 225 |
| 633021M | 21 | 32 | 36 | 52 | 16 | 228 |
| 633022M | 22 | 33 | 36 | 52 | 16 | 230 |
| 633023M | 23 | 34 | 36 | 52 | 16 | 237 |
| 633024M | 24 | 35 | 36 | 52 | 17 | 240 |
| 633026M | 26 | 36 | 35 | 52 | 17 | 243 |
| 633027M | 27 | 38 | 36 | 52 | 19 | 238 |
| 633028M | 28 | 39 | 36 | 52 | 19 | 233 |
| 633029M | 29 | 40 | 38 | 52 | 19 | 261 |
| 633030M | 30 | 42 | 38 | 54 | 21 | 295 |
| 633032M | 32 | 44 | 38 | 56 | 23 | 317 |
| 633033M | 33 | 46 | 40 | 56 | 23 | 351 |



KING TONY

Enjoy your work

| | | | | | | |
|---------|----|----|----|----|----|------|
| 633034M | 34 | 47 | 42 | 57 | 24 | 400 |
| 633035M | 35 | 48 | 42 | 58 | 25 | 406 |
| 633036M | 36 | 50 | 42 | 58 | 25 | 434 |
| 633038M | 38 | 52 | 45 | 60 | 27 | 497 |
| 633041M | 41 | 56 | 45 | 64 | 29 | 581 |
| 633042M | 42 | 57 | 45 | 64 | 29 | 591 |
| 633046M | 46 | 62 | 47 | 68 | 34 | 724 |
| 633048M | 48 | 64 | 48 | 70 | 34 | 775 |
| 633050M | 50 | 68 | 48 | 72 | 34 | 889 |
| 633054M | 54 | 72 | 50 | 75 | 35 | 1070 |
| 633055M | 55 | 74 | 50 | 76 | 37 | 1115 |
| 633058M | 58 | 77 | 50 | 78 | 37 | 905 |
| 633060M | 60 | 80 | 50 | 78 | 40 | 1250 |
| 633063M | 63 | 83 | 55 | 81 | 40 | 1445 |
| 633065M | 65 | 85 | 58 | 83 | 43 | 1565 |
| 633070M | 70 | 92 | 58 | 88 | 46 | 1875 |