

## 4575M



### 1/2" Kraft-Steckschlüssel für Torx®, lang

DIN 3121

- Für Außen-Torx®-Schrauben
- Chrom-Molybdän
- Phosphatiert

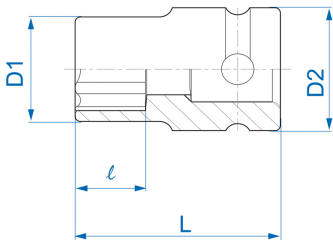

	N° Spitze	D1 (mm)	D2 (mm)	L (mm)	l (mm)	Gewicht (g)
457510M	E10	14	25	38	7.5	67
457512M	E12	15.9	25	38	9	69
457514M	E14	17.7	25	38	10	71
457516M	E16	20	25	38	11	76
457518M	E18	22	25	38	12.5	79
457520M	E20	24.5	30	38	14	118