

## 4B55





**M**

### 1/2" 6-Kant Kraft-Steckschlüsseleinsatz, metrisch, mit Kardangelenk

DIN3121

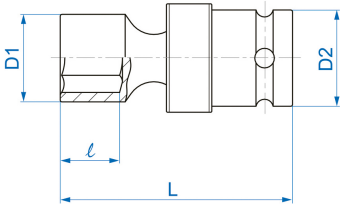
- Metrisch
- Ideal für Arbeiten unter beengten Bedingungen
- Chrom-Molybdän
- Phosphatiert



	Abmessungen (mm)	D1 (mm)	D2 (mm)	L (mm)	l (mm)	Gewicht (g)
4B5510M	10	17	27.5	64	12	161
4B5511M	11	19	27.5	64	12	166
4B5512M	12	19	27.5	64	12	162
4B5513M	13	21.8	27.5	64	12	176
4B5514M	14	22	27.5	64	12	174
4B5515M	15	22	27.5	64	12	172
4B5516M	16	23.9	27.5	64	12	180
4B5517M	17	25	27.5	64	12	173
4B5521M	21	30	27.5	64	12	190
4B5522M	22	31.7	27.5	64	12	196