

6515S





S

3/4" 6-Kant Kraft-Steckschlüsseinsatz, Zoll, schlanke Version

ANSI / ASME B107.2

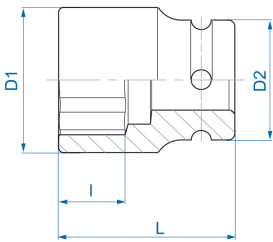
- Zoll
- Chrom-Molybdän, phosphatiert



	Abmessung (Zoll)	D1 (mm)	D2 (mm)	L (mm)	l (mm)	Gewicht (g)
651524S	3/4"	32	38	50	11	239
651530S	15/16"	38	40	50	15	293