

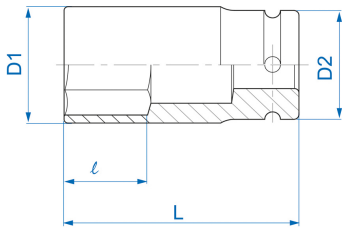

## 6935S



**S** 3/4" 6-Kant Kraft-Steckschlüsseinsatz, Zoll, schlanke Version

ANSI / ASME B107.2

- Zoll
- Chrom-Molybdän
- Phosphatiert

	Abmessung (Zoll)	D1 (mm)	D2 (mm)	L (mm)	l (mm)	Gewicht (g)
693524S	3/4"	30	38	90	16	370
693530S	15/16"	36.5	38	90	23	415