

## 6475M



### Kraft-Steckschlüsseleinsatz, lang, für Torx®, 3/4"

DIN 3121

- Legierter Stahl (Cr-Mo)
- Schwarz-phosphatiert

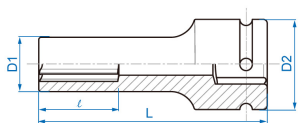

	Abmessungen (mm)	D1 (mm)	D2 (mm)	L (mm)	l (mm)	Gewicht (g)
647518M	E18	26.5	44	110	12.5	592
647520M	E20	29.0	44.0	110	14.0	627
647522M	E22	31.0	44	110	15.0	662
647524M	E24	32.5	44	110	17.0	693