

3535M





M

Vaso de impacto hexagonal en métrico 3/8"

DIN 3129

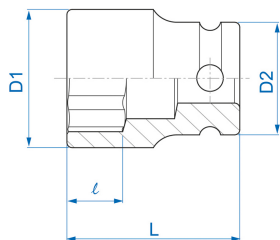
- en métrico
- Cromo molibdeno
- Acabado fosfato



	Dimensión (mm)	D1 (mm)	D2 (mm)	L (mm)	l (mm)	Peso (g)
353506M	6	10,6	19	32	5	31
353507M	7	11,8	19	32	5	33
353508M	8	13,2	19	32	6	34
353509M	9	14,5	19	32	6	39
353510M	10	15,5	19	32	7	38
353511M	11	17,0	19	32	7	38
353512M	12	18,2	19	32	8	41
353513M	13	19,4	22	32	9	53
353514M	14	20,7	22	32	9	54
353515M	15	22,0	22	32	10	55
353516M	16	23,3	22	32	10	57
353517M	17	24,5	22	32	11	60
353518M	18	25,8	22	32	11	63



KING TONY

Enjoy your work

353519M

19

27,0

22

32

11

64