

4014M



M Douille de vidange métrique 4 pans 1/2"

DIN 3120

- Métrique
- Pour vis carré de vidange
- Chrome Vanadium, finition chromée polie

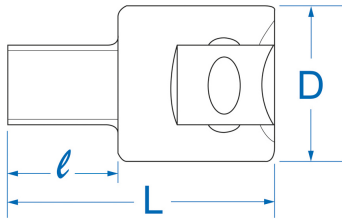

	Dimension (mm)	ø D (mm)	L (mm)	l (mm)	Poids (g)
401408M	8	23.5	35	13.5	60
401409M	9.5	23.5	35	13.5	68
401410M	10	23.5	35	13.5	72
401411M	10.5	23.5	35	13.5	78
401412M	12	23.5	35	13.5	90
401413M	12.7	23.5	35	13.5	97
401414M	13.5	23.5	35	13.5	106
401419M	19	25	38	15.5	130