

9AW4911

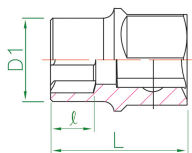

Douille Automobile 6 pans 1/2"

- Conçue pour le montage/démontage des poulies débrayables TOYOTA ALTIS
- 6 pans
- Finition chromée polie

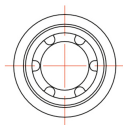

	Dimension (mm)	D1 (mm)	L (mm)	l (mm)	Poids (g)
9AW4911	M10S	19	33.8	10	46