

2535M



M Douille à chocs standard métrique 6 pans 1/4"

DIN 3129

- Métrique
- Chrome molybdenum
- Finition phosphatée

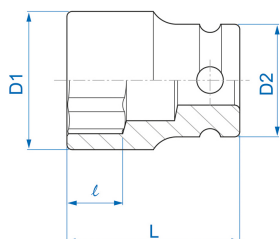

	Dimension (mm)	D1 (mm)	D2 (mm)	L (mm)	l (mm)	Poids (g)
253504M	4	7,5	13	23	4	12
253545M	4,5	8,1	13	23	5	12
253505M	5	8,8	13	23	6	12
253506M	6	10	13	23	7	13
253507M	7	11,3	13	23	7	13
253508M	8	12,5	13	23	8	13
253509M	9	13,8	13	23	8	15
253511M	11	16,3	13	23	9	20
253512M	12	17,5	13	23	9	21
253513M	13	18,8	13	23	9	22