

## 3535S



### **S** Douille à chocs standard en pouces 6 pans 3/8"

ANSI / ASME B107.1

- Dimensions en pouces
- Chrome molybdenum
- Finition phosphatée

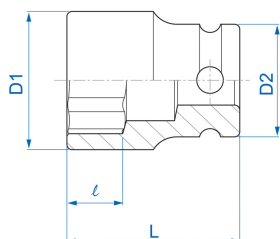

	Dimension (pouces)	D1 (mm)	D2 (mm)	L (mm)	l (mm)	Poids (g)
353508S	1/4"	10,8	19	32	5	31
353510S	5/16"	13	19	32	6	34
353512S	3/8"	15,3	19	32	7	38
353514S	7/16"	17	19	32	7	38
353516S	1/2"	18,2	19	32	9	53
353518S	9/16"	20,7	22	32	9	53
353520S	5/8"	23,8	22	32	10	57
353522S	11/16"	24,5	22	32	11	60
353524S	3/4"	27	22	32	11	64