

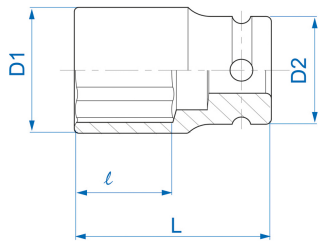

## 4835M



### **M** Douille à chocs longue à paroi fine métrique 6 pans 1/2"

DIN 3121

- Métrique
- Chrome molybdenum
- Finition phosphatée

	Dimension (mm)	D1 (mm)	D2 (mm)	L (mm)	l (mm)	Poids (g)
483510M	10	16	25	52	20	92
483511M	11	17	25	52	20	92
483512M	12	18	25	52	20	92
483513M	13	19	25	52	20	95
483514M	14	21	25	52	20	101
483516M	16	23	25	52	20	149
483517M	17	25	25	52	23	152
483519M	19	27	30	52	23	148
483521M	21	29	30	52	25	152
483522M	22	31	30	52	25	164
483523M	23	32	30	52	26	172
483524M	24	33	30	52	26	174
483526M	26	36	30	65	27	241



**KING TONY**

*Enjoy your work*

483527M	27	37	30	65	27	248
483530M	30	41	30	65	27	296
483535M	35	46	30	70	32	367