

## 4530S



### **S** Douille à chocs en pouces 12 pans 1/2"

ANSI/ASME B107.2

- Dimensions en pouces
- 12 pans
- Chrome molybdenum
- Finition phosphatée

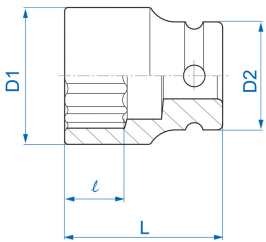

|  | Dimension (pouces) | D1 (mm) | D2 (mm) | L (mm) | l (mm) | Poids (g) |
|--|--------------------|---------|---------|--------|--------|-----------|
| 453016S  | 1/2"               | 20      | 25      | 38     | 10     | 71        |
| 453018S  | 9/16"              | 22      | 25      | 38     | 10     | 71        |
| 453020S  | 5/8"               | 24      | 25      | 38     | 11     | 111       |
| 453022S  | 11/16"             | 26      | 30      | 38     | 12     | 116       |
| 453024S  | 3/4"               | 28      | 30      | 38     | 13     | 119       |
| 453026S  | 13/16"             | 30      | 30      | 40     | 14     | 125       |
| 453028S  | 7/8"               | 32      | 30      | 40     | 14     | 141       |
| 453030S  | 15/16"             | 34      | 30      | 42     | 15     | 152       |
| 453032S  | 1"                 | 36      | 30      | 42     | 15     | 168       |
| 453034S  | 1-1/16"            | 38      | 30      | 44     | 16     | 176       |
| 453036S  | 1-1/8"             | 41      | 30      | 44     | 17     | 194       |
| 453038S  | 1-3/16"            | 42      | 30.5    | 44     | 17     | 209       |