

6515S



S Douille à chocs standard, en pouces, 6 pans, carré conducteur fin 3/4"

ANSI / ASME B107.2

- Dimensions en pouces
- Chrome molybdenum, Finition phosphate

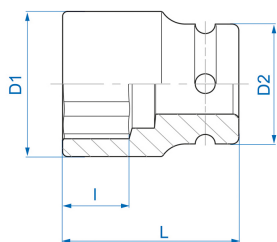

	Dimension (pouces)	D1 (mm)	D2 (mm)	L (mm)	l (mm)	Poids (g)
651524S	3/4"	32	38	50	11	239
651530S	15/16"	38	40	50	15	293