

## 6535M



### M Douille à chocs standard métrique 6 pans 3/4"

DIN 3129

- Métrique
- Chrome molybdenum
- Finition phosphatée

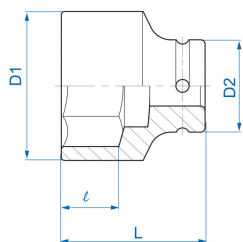

	Dimension (mm)	D1 (mm)	D2 (mm)	L (mm)	l (mm)	Poids (g)
653517M	17	29	44	50	10	316
653518M	18	30	44	50	10	324
653519M	19	32	44	50	10	329
653521M	21	35	44	50	13	341
653522M	22	36	44	50	13	346
653523M	23	37	44	50	15	350
653524M	24	38	44	50	15	352
653526M	26	40	44	53	15	358
653527M	27	42	44	53	18	380
653528M	28	44	44	53	18	394
653529M	29	45	44	53	18	404
653530M	30	46	44	53	20	412
653532M	32	48	44	57	20	460



# KING TONY

*Enjoy your work*

653533M	33	50	44	57	20	479
653534M	34	51	44	57	22	491
653535M	35	52	44	57	22	497
653536M	36	53	44	57	22	519
653538M	38	56	44	57	22	540
653540M	40	58	44	58	22	567
653541M	41	59	44	58	24	580
653542M	42	61	44	58	24	616
653543M	43	62	44	58	24	636
653544M	44	64	44	62	24	676
653546M	46	66	44	62	24	717
653548M	48	68	54	65	26	925
653550M	50	71	54	65	26	955
653552M	52	74	54	68	30	1085
653554M	54	76	54	68	30	1125
653555M	55	77	54	70	30	1160
653557M	57	79	54	70	32	1198
653558M	58	81	54	70	32	1226
653560M	60	84	54	70	32	1313
653563M	63	84.5	54	80	40	1341
653565M	65	86.5	54	80	43	1358
653513M	13	22	38	50	16	205
653531M	31	47	44	53	20	413