

6511C

Pince multiprise standard

DIN ISO 8976



- Crémaillère à 7 positions
- Acier forgé
- Denture épaisse
- Poignées en PVC
- Finition brunie

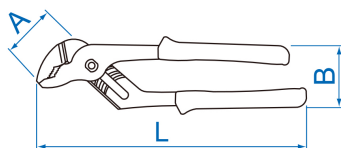
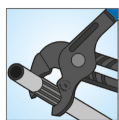

	A (mm)	B (mm)	L (mm)	L (pouces)	Ouverture max (mm)	Poids (g)
651110C	33	50	253	10"	50	400
651113C	43	50	325	13"	65	808
651117C	58	55	425	17"	100	1150