

6516C

Pince multiprises à branches entrepassées

DIN ISO 8976



- 7 positions
- Acier forgé
- Charnière entrepassée
- Poignées en PVC
- Denture épaisse
- Finition brunie

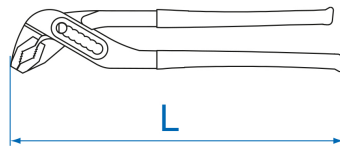
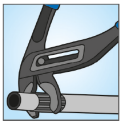

	A (mm)	B (mm)	L (mm)	L (pouces)	Ouverture max (mm)	Poids (g)
651610C	58	61	253	10"	36	300