

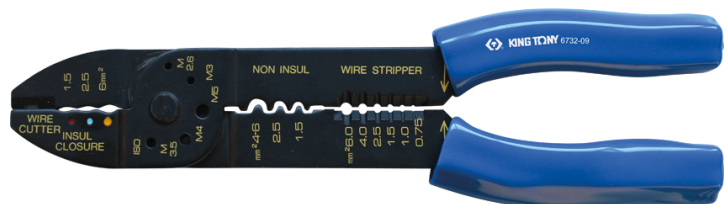

6732

Pince à sertir standard pour cosses pré-isolées

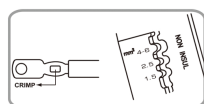
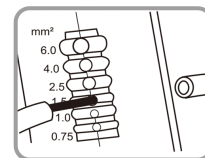
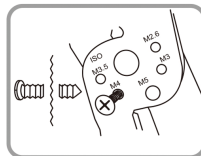
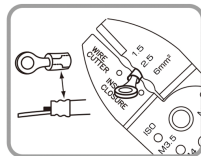
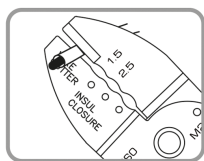

- Coupe fil intégré
- Poignée PP
- Finition brunie



	Longueur (mm)	Coupe-boulons (mm)	Dénudage (mm ²)	Coupe-fil (ø mm)	Sertissage de cosses isolées et pré-isolées (mm ²)	Poids (g)
673209	230	M2.6, M3, M3.5, M4, M5	0.75, 1, 1.5, 2.5, 4, 6	6	1.5, 2.5, 6 mm ²	261