

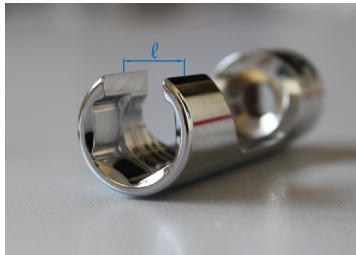

## 32H522S

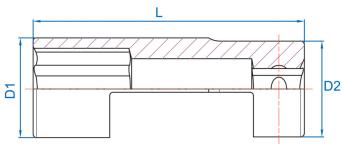

### **S** 3/8" Inch Long 6-Point Open Socket

- Inch
- For DIESEL CUMMINS engine
- Open socket to allow hose access



	Dimension (Inch)	D1 (mm)	D2 (mm)	L (mm)	l (mm)	Weight (g)
32H522S	11/16"	25	24	81	13	111