

9AW4911

1/2" 6 points Automotive socket

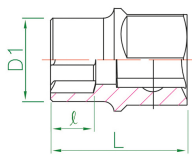

- Designed for the assembly and disassembly of the TOYOTA ALTIS detachable pulleys
- 6 Points
- Polished and chromed finish

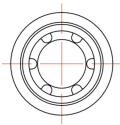

	Size (mm)	D1 (mm)	L (mm)	l (mm)	Weight (g)
9AW4911	M10S	19	33.8	10	46