

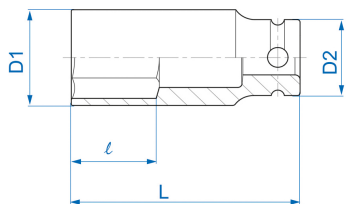

4430M



M 1/2" long metric 12 points impact socket

DIN 3121

- Metric
- Chrome molybdenum
- Phosphate finish

|  | Size (mm) | D1 (mm) | D2 (mm) | L (mm) | l (mm) | Weight (g) |
|--|-----------|---------|---------|--------|--------|------------|
| 443008M | 8 | 14 | 25 | 78 | 12 | 130 |
| 443009M | 9 | 15 | 25 | 78 | 12 | 135 |
| 443010M | 10 | 17 | 25 | 80 | 12 | 150 |
| 443011M | 11 | 18 | 25 | 80 | 13 | 160 |
| 443012M | 12 | 19 | 25 | 80 | 14 | 170 |
| 443013M | 13 | 20 | 25 | 80 | 14 | 165 |
| 443014M | 14 | 22 | 25 | 80 | 14 | 180 |
| 443015M | 15 | 23 | 30 | 80 | 16 | 236 |
| 443016M | 16 | 24 | 30 | 80 | 16 | 243 |
| 443017M | 17 | 26 | 30 | 80 | 16 | 255 |
| 443018M | 18 | 27 | 30 | 80 | 17 | 267 |
| 443019M | 19 | 28 | 30 | 80 | 18 | 260 |
| 443020M | 20 | 29.2 | 30 | 80 | 20 | 252 |



KING TONY

Enjoy your work

| | | | | | | |
|---------|----|----|------|----|----|-----|
| 443021M | 21 | 30 | 30 | 80 | 20 | 251 |
| 443022M | 22 | 32 | 30 | 80 | 22 | 304 |
| 443023M | 23 | 33 | 30 | 80 | 24 | 310 |
| 443024M | 24 | 34 | 30 | 80 | 24 | 318 |
| 443027M | 27 | 38 | 30 | 80 | 27 | 368 |
| 443030M | 30 | 42 | 30.5 | 80 | 30 | 422 |
| 443032M | 32 | 46 | 30 | 80 | 32 | 460 |
| 443036M | 36 | 47 | 30 | 80 | 36 | 535 |