

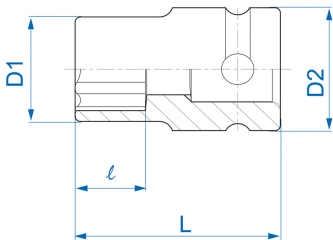

6575M



3/4" Torx® impact socket

- Chrome molybdenum
- Phosphate finish
- For TORX male screws
- Adapted to SCANIA crankshaft bearings.



|  | N° Tip | D1 (mm) | D2 (mm) | L (mm) | l (mm) | Weight (g) |
|--|--------|---------|---------|--------|--------|------------|
| 657524M | E24 | 32 | 44 | 50 | 18 | 340 |
| 657526M | E26 | 35 | 44 | 60 | 21 | 410 |
| 657528M | E28 | 36 | 44 | 60 | 27 | 410 |
| 657530M | E30 | 37 | 44 | 65 | 32 | 435 |
| 657532M | E32 | 39 | 44 | 65 | 28 | 450 |