

8435S



S Long imperial 6 points impact socket

ANSI / ASME B107.1

- Inch
- Chrome molybdenum, phosphate finish

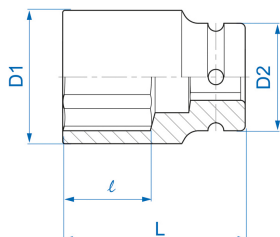

|  | Dimension (Inch) | D1 (mm) | D2 (mm) | L (mm) | l (mm) | Weight (g) |
|--|------------------|---------|---------|--------|--------|------------|
| 843530S | 15/16" | 41 | 54 | 90 | 25 | 850 |
| 843532S | 1" | 42 | 54 | 90 | 25 | 860 |
| 843534S | 1-1/16" | 44 | 54 | 90 | 25 | 879 |
| 843536S | 1-1/8" | 47 | 54 | 90 | 25 | 900 |
| 843538S | 1-3/16" | 48 | 54 | 90 | 28 | 916 |
| 843540S | 1-1/4" | 51 | 54 | 90 | 28 | 979 |
| 843542S | 1-5/16" | 52 | 54 | 92 | 28 | 1016 |
| 843544S | 1-3/8" | 54 | 54 | 92 | 28 | 1016 |
| 843546S | 1-7/16" | 56 | 54 | 92 | 32 | 1033 |
| 843548S | 1-1/2" | 58 | 54 | 92 | 32 | 1025 |
| 843550S | 1-9/16" | 60 | 54 | 92 | 32 | 1075 |
| 843552S | 1-5/8" | 61 | 54 | 92 | 32 | 1083 |
| 843554S | 1-11/16" | 64 | 54 | 92 | 32 | 1100 |

| | | | | | | |
|---------|----------|----|----|-----|----|------|
| 843556S | 1-3/4" | 67 | 54 | 92 | 32 | 1120 |
| 843558S | 1-13/16" | 68 | 54 | 95 | 35 | 1137 |
| 843560S | 1-7/8" | 70 | 54 | 95 | 35 | 1400 |
| 843562S | 1-15/16" | 72 | 54 | 95 | 35 | 1480 |
| 843564S | 2" | 74 | 54 | 95 | 35 | 1577 |
| 843566S | 2-1/16" | 75 | 54 | 100 | 40 | 1637 |
| 843568S | 2-1/8" | 78 | 54 | 100 | 40 | 1750 |
| 843570S | 2-3/16" | 79 | 54 | 100 | 40 | 1862 |
| 843572S | 2-1/4" | 82 | 54 | 100 | 42 | 1900 |