

6516C

Twin slip-Groove joint pliers

DIN ISO 8976



- 7 Positions
- Twin-slip groove joint pliers
- Forged steel
- Grip material - PVC
- Coarse serrated
- Phosphate finish

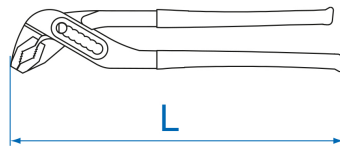
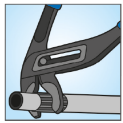

	A (mm)	B (mm)	L (mm)	L (inch)	Opening max (mm)	Weight (g)
651610C	58	61	253	10"	36	300