

6516A

VDE insulated groove joint pliers

IEC DIN EN 60900



- Forged steel
- Ergonomic handle TPR security 1000V
- 7 Positions
- Phosphate finish

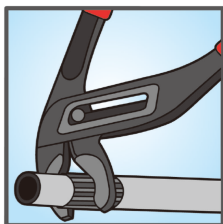
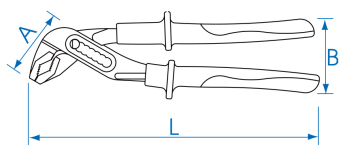

	A (mm)	B (mm)	L (mm)	L (inch)	Opening max (mm)	Weight (g)
651610A	55	63	250	10	36	420