

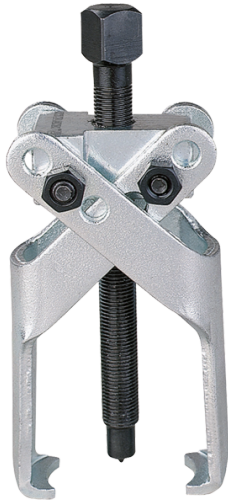

796226

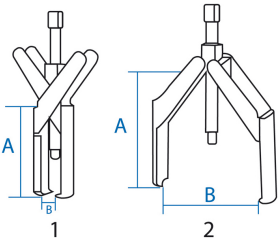

Cross-jaw pullers for sprocket

- For an external extraction
- Wide-Claw version
- Articulated claws
- One-piece claw design
- Thin threading



	Breadth of scope B Max (mm)	Breadth of scope B Min (mm)	Deep capacity A (mm)	Power (T)	Characteristics of the screw (mm)	Hex drive	Square drive	Screw spare parts	Weight (g)
79622641	95	55	90	1	M10x1	-	12		300
79622642	125	70	125	4	M14x1,50	-	16		800
79622643	125	80	160	7	M14x1,50	19	-		1000