

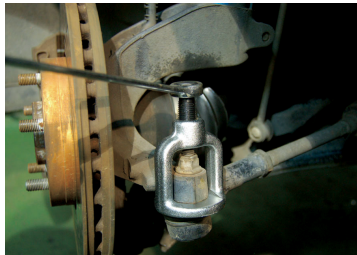

## 9BE4\_

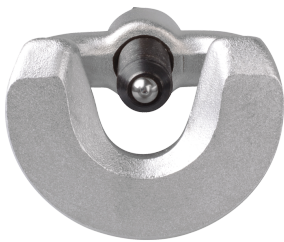

### Direct action ball joint extractor

- Designed to extract the directions and stabilizer rods, directions ball joints and various ball joints
- Compatible with all kinds of trucks and vehicles



	Max torque (Nm)	Width of the opening A1 (mm)	Width of the opening A2 (mm)	Deep capacity A (mm)	Characteristics of the screw (mm)	Hex drive	Weight (g)
9BE41	50	18	40	35	M14 x 1,5	17	400
9BE42	120	23	50	45	M16 x 1,5	17	600
9BE43	160	29	60	55	M18 x 1,5	19	900
9BE44	280	40	80	80	1/2" 14h	22	2200
9BE45	400	46	90	100	1/2" 14h	-	2300