

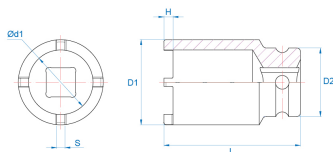

44K7



1/2" External KM Locknut Socket

- For loosening and tightening KM nuts of DIN 981 ball bearings
- Thin wall
- To be used with extensions, ratchets etc.
- Application: Removal and installation of bearings, gear wheels, cone roll bearings, ball bearings etc.
- Trucks, landscaping, forestry and construction machines, etc.
- Made of CR-MO (chrome-molybdenum steel)
- Finish: black phosphated



	N° Tip	ø external of the nut (mm)	D1 (mm)	H (mm)	S (mm)	D2 (mm)	ød1 (mm)	L (mm)	Weight (g)
44K732M	TMFS 4	32	37.3	4	3.5	30	28.3	60	207
44K738M	TMFS 5	38	44.3	5	4.6	30	34.3	60	259
44K745M	TMFS 6	45	52.3	5	4.6	30	41.3	60	321
44K758M	TMFS 8	58	65.5	7	5.6	30	53.5	60	422
44K752M	TMFS 7	52	59.3	6	4.6	30	48.3	60	350