

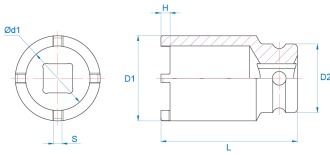

64K7



3/4" External KM Locknut Socket

- For loosening and tightening KM nuts of DIN 981 ball bearings
- Thin wall
- To be used with extensions, ratchets etc.
- Application: Removal and installation of bearings, gear wheels, cone roll bearings, ball bearings etc.
- Trucks, landscaping, forestry and construction machines, etc.
- Made of CR-MO (chrome-molybdenum steel)
- Finish: black phosphated



	N° Tip	ø external of the nut (mm)	D1 (mm)	H (mm)	S (mm)	D2 (mm)	ød1 (mm)	L (mm)	Weight (g)
64K765M	TMFS 9	65	73.5	8	5.6	42	60.5	68	601
64K770M	TMFS 10	70	78.5	9	5.6	42	65.5	68	625
64K775M	TMFS 11	75	82.5	9	6.7	42	69.5	68	664
64K780M	TMFS 12	80	87.5	8.5	6.7	42	74.5	68	691