

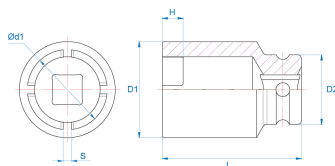

64K8



3/4" Internal KM Locknut Socket

- For loosening and tightening KM nuts of DIN 981 ball bearings
- Thin wall
- To be used with extensions, ratchets etc.
- Application: Removal and installation of bearings, gear wheels, cone roll bearings, ball bearings etc.
- Trucks, landscaping, forestry and construction machines, etc.
- Made of CR-MO (chrome-molybdenum steel)
- Finish: black phosphated



	N° Tip	ø external of the nut (mm)	D1 (mm)	H (mm)	S (mm)	D2 (mm)	ød1 (mm)	L (mm)	Weight (g)
64K865M	TMFS 9	65	80	12	5.6	42	67.4	68	915
64K870M	TMFS 10	70	86	13	5.6	42	72.4	68	1022
64K875M	TMFS 11	75	93	13	6.7	42	78.2	68	1167
64K880M	TMFS 12	80	98	13	6.7	42	83	68	1329