

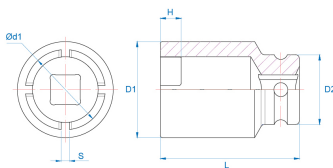

44K8



1/2" Internal KM Locknut Socket

- For loosening and tightening KM nuts of DIN 981 ball bearings
- Thin wall
- To be used with extensions, ratchets etc.
- Application: Removal and installation of bearings, gear wheels, cone roll bearings, ball bearings etc.
- Trucks, landscaping, forestry and construction machines, etc.
- Made of CR-MO (chrome-molybdenum steel)
- Finish: black phosphated



	N° Tip	ø external of the nut (mm)	D1 (mm)	H (mm)	S (mm)	D2 (mm)	ød1 (mm)	L (mm)	Weight (g)
44K832M	TMFS 4	32	41	9	3.5	30	34	60	282
44K838M	TMFS 5	38	49.5	10	4.6	30	40	60	365
44K845M	TMFS 6	45	60	10	4.6	30	47.6	60	474
44K852M	TMFS 7	52	66	10.5	4.6	30	54.4	60	540
44K858M	TMFS 8	58	73	12.5	5.6	30	60.4	60	582