

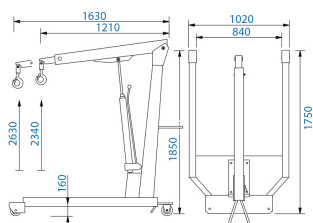

## 9HYGR20



### Hydraulic workshop crane for auto workshops and industry

- Jib arm with large lifting capacity, even in 5th position.
- Built-in safety overload valve.
- Manual dead man's release for optimum safety when lowering.
- Pump rotates through 360° for excellent operation in all working conditions.
- Fitted with 2 castors and 2 fixed wheels for easy manoeuvrability even with maximum load.
- Lifting hook pivots 360°
- Inner frame width enables use with Euro pallets.
- Hard chromium plated piston rod and pump piston for long life.
- 5 positions = 5 capacities: 2000 kg, 1900 kg, 1800 kg, 1700 kg, 1600 kg



	Capacity (ton)	Minimum Height H1 (mm)	Maximum height H2 (mm)	Extraction arm L5 (mm)	Frame height H4 (mm)	Frame length L1 (mm)	Inner width L6 (mm)	Frame width L7 (mm)	Height H5 (mm)	Weight (kg)
9HYGR20	2	2340	2630	1210	160	1750	840	1020	1850	250