

9TYN13



Hydraulic Jack (2, 3 t)

CE

- Handle with dead man device (automatic turning handle).
- Ergonomic handle with 2 hands.
- Double pumps.
- Descent speed control system.
- Sandblasted body and anti-scratch paint.
- Pedal with rubber coating.
- Spare parts tray.
- Fiberglass and nylon wheel.

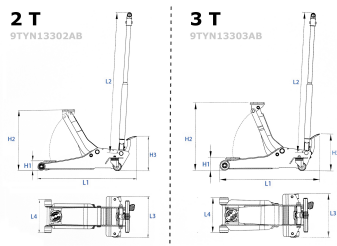

	Capacity (ton)	Minimum Height H1 (mm)	Maximum height H2 (mm)	Frame length L1 (mm)	Handle length L2 (mm)	Frame height H3 (mm)	Width with wheels L4 (mm)	Width L3 (mm)	Handle width (mm)	Weight (kg)
9TYN13302AB	2	75	500	770	1100	264	282	353	270	32.9
9TYN13303AB	3	95	515	770	1100	284	296	367	270	