

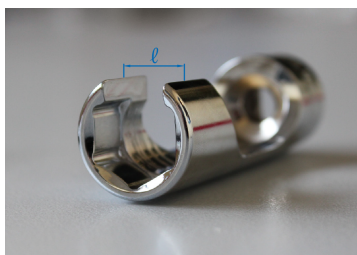

32H522S

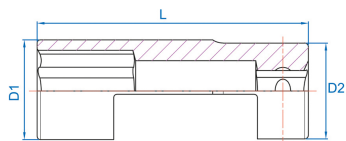

S Chiave a bussola aperta lunga, in pollici - esagonale 3/8"

- Pollici
- Per motore CUMMINS DIESEL
- Bussola aperta per consentire il passaggio di un tubo di gomma



	Dimensione (Inch)	D1 (mm)	D2 (mm)	L (mm)	l (mm)	Peso (g)
32H522S	11/16"	25	24	81	13	111