

9AW4911

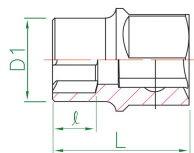

Chiave a bussola esagonale Automobile 1/2"

- Progettata per il montaggio delle pulegge disinnestabili TOYOTA ALTIS
- 6 Lati
- Finizione cromata lucidata

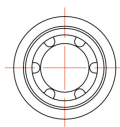

	Dimensioni (mm)	D1 (mm)	L (mm)	l (mm)	Peso (g)
9AW4911	M10S	19	33.8	10	46