

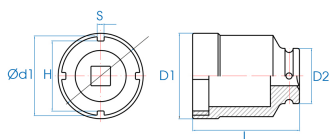

44K9

M Chiave a bussola per dadi ad intacche 1/2"



- Sockets for SKF - TMFS Series locknuts
- Easier passage around the bearing compared to a hook wrench
- The SKF TMFS model is suitable for KM, KMK (metric) and KMF series
- Cromo Vanadio
- Finizione fosfatata



	Dimensioni (mm)	Impronta N°	D1 (mm)	H (mm)	S (mm)	D2 (mm)	ød1 (mm)	L (mm)	Peso (g)
44K928M	28	TMFS 3	36	24.4	3.8	30	30	90	382
44K932M	32	TMFS 4	38	28.4	3.8	30	34	90	378
44K938M	38	TMFS 5	46	34.4	4.8	30	40	90	559