

3575M



Chiave a bussola ad impatto standard per viti maschio Torx® 3/8"

DIN 3121

- Per viti maschio Torx®
- Cromo molibdeno
- Finizione fosfatata

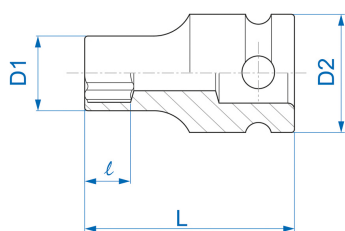

	Impronta N°	D1 (mm)	D2 (mm)	L (mm)	l (mm)	Peso (g)
357505M	E5	9,6	19	32	4,0	31
357506M	E6	10,2	19	32	5,0	31
357507M	E7	10,8	19	32	6,0	33
357508M	E8	11,5	19	32	6,5	33
357510M	E10	12,0	19	32	7,0	34
357512M	E12	14,0	19	32	9,0	34
357514M	E14	17,0	19	32	9,5	40