

## 4530M



### M Chiave a bussola ad impatto standard metrica bi-esagonale 1/2"

DIN 3129

- Metrico
- Cromo molibdeno
- Finizione fosfatata

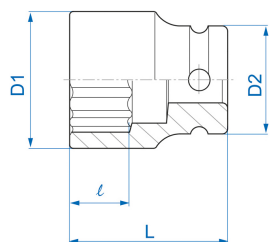

	Dimensioni (mm)	D1 (mm)	D2 (mm)	L (mm)	l (mm)	Peso (g)
453008M	8	14.5	25	38	7	67
453010M	10	17	25	38	8	70
453011M	11	18.5	25	38	8	71
453012M	12	19.5	25	38	9	72
453013M	13	20.5	25	38	10	72
453014M	14	22	25	38	10	77
453015M	15	23.2	30	38	11	112
453016M	16	24.5	30	38	11	112
453017M	17	26.2	30	38	12	115
453018M	18	27.2	30	38	13	115
453019M	19	28.2	30	38	13	120
453020M	20	29.5	30	38	13	120
453021M	21	30	30	40	14	125



**KING TONY**

*Enjoy your work*

453022M	22	32	30	40	14	143
453023M	23	33.2	30	40	15	143
453024M	24	34.5	30	42	15	152
453025M	25	36	30	42	15	168
453026M	26	37	30	42	15	173
453027M	27	38	30	44	16	176
453030M	30	42.5	30.5	44	17	201
453032M	32	44.5	30	44	18	205
453034M	34	45	30	46	18	231
453036M	36	47	30	46	19	248
453038M	38	50	30	50	21	248
453009M	9	16.3	25	38	7	68
453028M	28	41	30	44	16	205
453029M	29	41	30	44	17	184
453033M	33	46	30	46	19	246
453041M	41	56	30	52	22	402