

4435S



S Chiave a bussola ad impatto lunga pollici esagonale 1/2"

ANSI / ASME B107.2

- Pollici
- Cromo molidbeno
- Finizione fosfatata

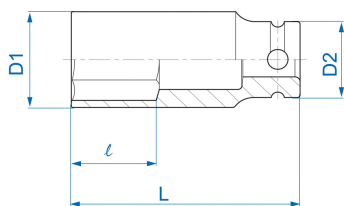

	Dimensione (Inch)	D1 (mm)	D2 (mm)	L (mm)	l (mm)	Peso (g)
443510S	5/16"	14	25	78	12	123
443512S	3/8"	17	25	80	12	148
443514S	7/16"	18	25	80	13	148
443516S	1/2"	20	25	80	14	159
443518S	9/16"	22	25	80	14	170
443520S	5/8"	24	25	80	16	232
443522S	11/16"	26	30	80	17	235
443524S	3/4"	28	30	80	20	251
443526S	13/16"	30	30	80	22	243
443528S	7/8"	32	30	80	22	292
443530S	15/16"	34	30	80	24	308
443532S	1"	36	30	80	24	336
443534S	1-1/16"	38	30	80	27	356

443536S	1-1/8"	41	30	80	27	401
443538S	1-3/16"	42	30,5	80	30	409
443540S	1-1/4"	44	30	80	32	423
443542S	1-5/16"	46	30	80	34	476