

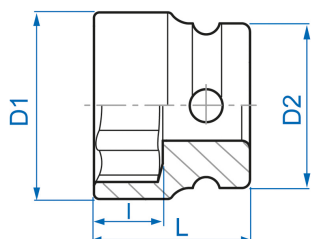

4525M

M Chiave a bussola ad impatto mini metrica esagonale 1/2"

DIN 3129, ISO 2725-2

- Metrico
- 6 Lati
- Cromo molibdeno
- Finizione fosfatata



	Dimensioni (mm)	D1 (mm)	D2 (mm)	L (mm)	l (mm)	Peso (g)
452517M	17	26	26	28.5	5.5	64
452519M	19	28	26	28.5	10	63
452521M	21	30	30	28.5	10	81
452522M	22	32	30	28.5	10	87
452524M	24	34	30	28.5	12	80
452514M	14	22	26	28.5	5.5	61