

6515S



S Chiave a bussola ad impatto standard, esagonale, in pollici, quadro conduttore fino

ANSI / ASME B107.2

- Pollici
- Cromo molibdeno. Finizione fosfato

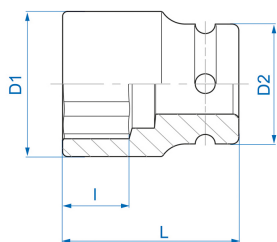

	Dimensione (Inch)	D1 (mm)	D2 (mm)	L (mm)	l (mm)	Peso (g)
651524S	3/4"	32	38	50	11	239
651530S	15/16"	38	40	50	15	293