

6435S



S Chiave a bussola ad impatto lunga pollici esagonale 3/4"

ANSI / ASME B107.2

- Pollici
- Cromo molibdeno
- Finizione fosfatata

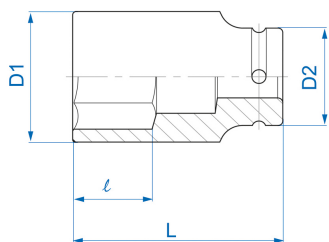

	Dimensione (Inch)	D1 (mm)	D2 (mm)	L (mm)	l (mm)	Peso (g)
643524S	3/4"	32	38	90	16	455
643526S	13/16"	35	38	90	18	490
643528S	7/8"	36	38	90	18	495
643530S	15/16"	37	38	90	23	495
643532S	1"	38	38	90	25	500
643534S	1-1/16"	42	44	90	27	624
643536S	1-1/8"	45	44	90	27	680
643538S	1-3/16"	46	44	90	27	684
643540S	1-1/4"	48	44	90	30	733
643542S	1-5/16"	50	44	90	30	789
643544S	1-3/8"	52	44	90	32	804
643546S	1-7/16"	54	44	90	32	844
643548S	1-1/2"	56	44	90	34	871

643550S	1-9/16"	58	44	90	34	928
643552S	1-5/8"	59	44	90	34	941
643554S	1-11/16"	62	44	95	38	1111
643556S	1-3/4"	64	44	95	38	1168
643558S	1-13/16"	66	44	95	38	1241
643560S	1-7/8"	68	54	95	40	1397
643562S	1-15/16"	70	54	95	40	1448
643564S	2"	72	54	95	40	1521