

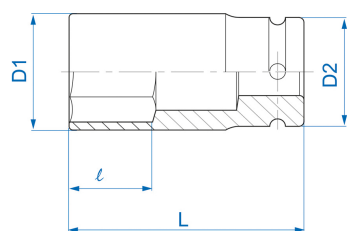

6935M



M Chiave a bussola ad impatto serie sottile metrica esagonale 3/4"

DIN 3121

- Metrico
- Cromo molidbeno
- Finizione fosfatata

	Dimensioni (mm)	D1 (mm)	D2 (mm)	L (mm)	l (mm)	Peso (g)
693521M	21	33	44	90	18	597
693524M	24	36.5	44	90	23	619
693527M	27	40	44	90	27	631
693532M	32	46.5	44	90	30	733