

## 9535M



### M Chiave a bussola ad impatto standard metrica esagonale 1-1/2"

DIN 3129

- Metrico
- Cromo molibdeno
- Finizione fosfatata

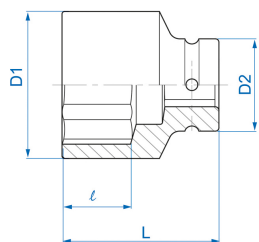

	Dimensioni (mm)	D1 (mm)	D2 (mm)	L (mm)	l (mm)	Peso (g)
953546M	46	73	86	85	28	2233
953550M	50	78	86	85	28	2300
953555M	55	85	86	93	30	2660
953560M	60	90	86	95	30	2840
953565M	65	96	86	100	35	3150
953570M	70	102	86	103	35	3460
953575M	75	108	86	105	38	3700
953580M	80	115	86	105	42	3900
953585M	85	121	86	105	42	4175
953590M	90	127	86	110	46	4600
953595M	95	135	127	110	50	7570
9535AOM	100	140	127	115	53	8104
9535A5M	105	146	127	115	53	8340

9535BOM	110	152	127	125	56	9400
9535B5M	115	160	127	125	60	9766
9535B7M	117	-	-	-	-	-
9535COM	120	166	127	130	62	10460
9535C5M	125	172	127	135	65	11148
9535DOM	130	130	180	180	127	140
9535D5M	130	135	180	185	127	140
9535EOM	140	195	127	150	75	13570
9535FOM	150	200	127	155	80	14270