

6511C

Pinza regolabile standard

DIN ISO 8976



- Cremagliera 7 posizioni
- Acciaio forgiato
- Dentatura spessa
- Impugnatura di PVC
- Finizione Brunita

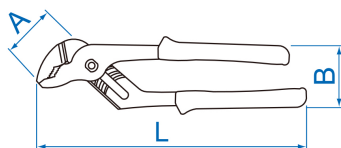
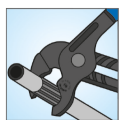

	A (mm)	B (mm)	L (mm)	L (inch)	Apertura max (mm)	Peso (g)
651110C	33	50	253	10"	50	400
651113C	43	50	325	13"	65	808
651117C	58	55	425	17"	100	1150