

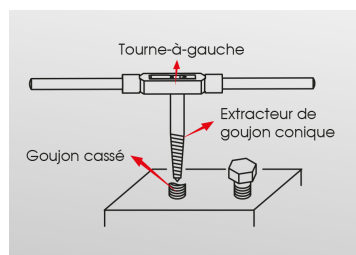

9BE2127

Estrattori di viti prigioniera coniche

- Per un'estrazione dei perni interni
- Da utilizzare con un giramaschi (serie 3911ML) oppure un porta-utensili a cricchetto (serie 3740ML o 3912M)

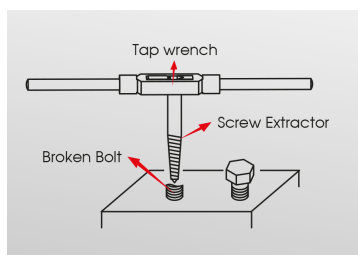
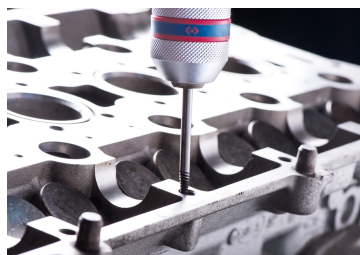

	Capacità (mm)	Capacità (inch)	L (mm)
9BE212706M	M3 ~ M6	1/8" ~ 1/4"	51.5
9BE212708M	M6 ~ M8	1/4" ~ 5/16"	58.0
9BE212711M	M8 ~ M11	5/16" ~ 7/16"	66.0
9BE212714M	M11 ~ M14	7/16" ~ 9/16"	73.5
9BE212718M	M14 ~ M18	9/16" ~ 3/4"	81.0
9BE212724M	M18 ~ M24	3/4" ~ 1"	92,2
9BE212733M	M24 ~ M33	1" ~ 1-3/8"	106,6
9BE212750M	M33 ~ M50	1-3/8" ~ 2"	111,7