

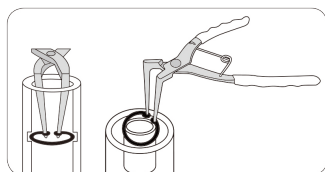

## 68HB07L

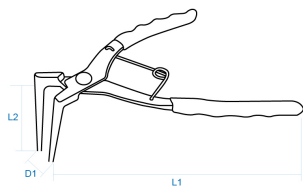

### Pinza per anelli elastici interni - Becchi lunghi conici 90°

- Per anelli elastici interni
- Modello a becchi extra lunghi e piegati a 90°, ideato per accedere negli spazi ridotti



	D1 (mm)	L1 (mm)	L2 (mm)	ø becco (mm)	ø dell'Anello elastico	Peso (g)
68HB07L	23	180	56	1,3	19~60	222