

3351M



M Gelede-Crowfoot-dopsleutel, metrisch, geopende 6-kantig, 3/8"

DIN 3120

- Metrisch
- Wordt gecombineerd met T- en L-handgrepen en gescharnierde verlengstukken
- 200° verstelbare kop
- Vanadiumchroom, afwerking in gepolijst chroom

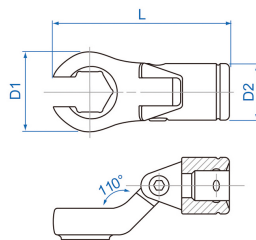
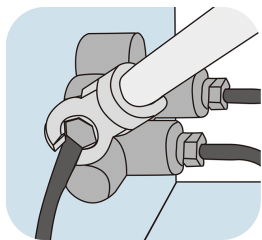

	Afmeting (mm)	D1 (mm)	D2 (mm)	L (mm)	Gewicht (g)
335108M	8	15	18.8	45	44
335109M	9	18	18.8	49	47
335110M	10	18	18.8	49	47
335111M	11	22	18.8	53	56
335112M	12	22	18.8	53	55
335113M	13	26	18.8	60	77
335114M	14	26	18.8	60	75
335115M	15	27	18.8	60	75
335116M	16	32	24.7	73.5	152
335117M	17	33	24.7	73.5	149
335118M	18	33	24.7	73.5	155
335119M	19	33.3	24.7	73.5	152